

ROHS COMPLIANT

1.27mm Micro Match Box Header IDC

SPECIFICATION

Current Rating: 1.0Amp
 Insulation Resistance: 1000MΩ min
 Contact Resistance: 20MΩ max
 Withstand Voltage: 500V AC/DC
 Operating Temperature: -40°C to +105°C
 Contact Material: Phosphor Bronze
 Contact Plating: Au Over Ni
 Insulator Material: PBT+30%GF UL 94V-0 Red

XX: NR. PIN
Y: A-TYPE 1
Y: B-TYPE 2

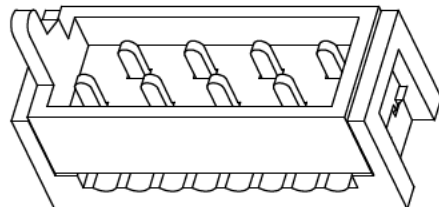
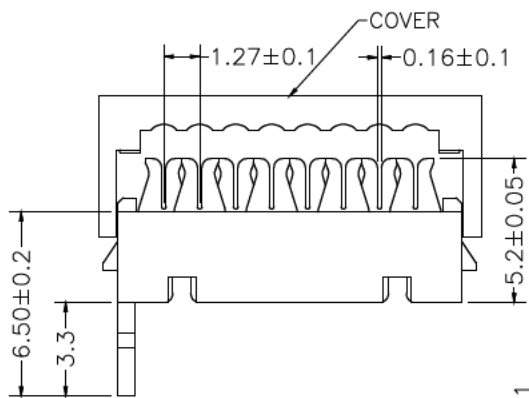
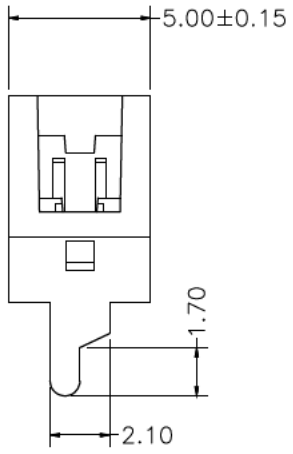

W/O BUMP Type1

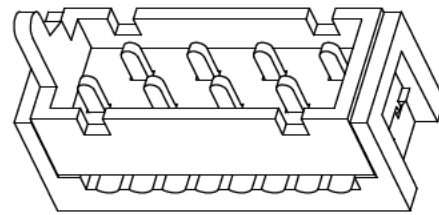
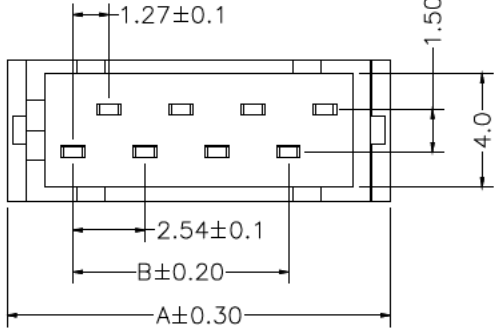

WITH BUMP Type2

POLES	DIM. A	DIM. B	QTY/Tube
4	8.45	2.54	68
6	10.99	5.08	52
8	13.53	7.62	42
10	16.07	10.16	36
12	18.61	12.7	31
14	21.15	15.24	27
16	23.69	17.78	24
18	26.23	20.32	22
20	28.77	22.86	20
26	36.39	30.48	16

Unless Otherwise specified tolerance
 X:±0.35
 X.X:±0.25
 X.XX:±0.20
 X.XXX:±0.15

SCALE: 2:1 UNIT: mm

DRAWN: Peter

CHECKED: Mark



TITLE:
1.27mm Micro Match Box Header IDC

DRAWING NO: SM C02 3135 XX Y

PRODUCT NO:

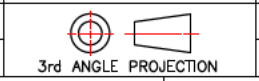

REV	DESCRIPTION	DATE
1	Add option of plating	10-08-28